

# HOT WATER CYLINDER

REF	SIZE	MAKE/MODEL
HW1	145DD	HEATRAE SADIA MEGAFLO ECO - DIRECT UNVENTED

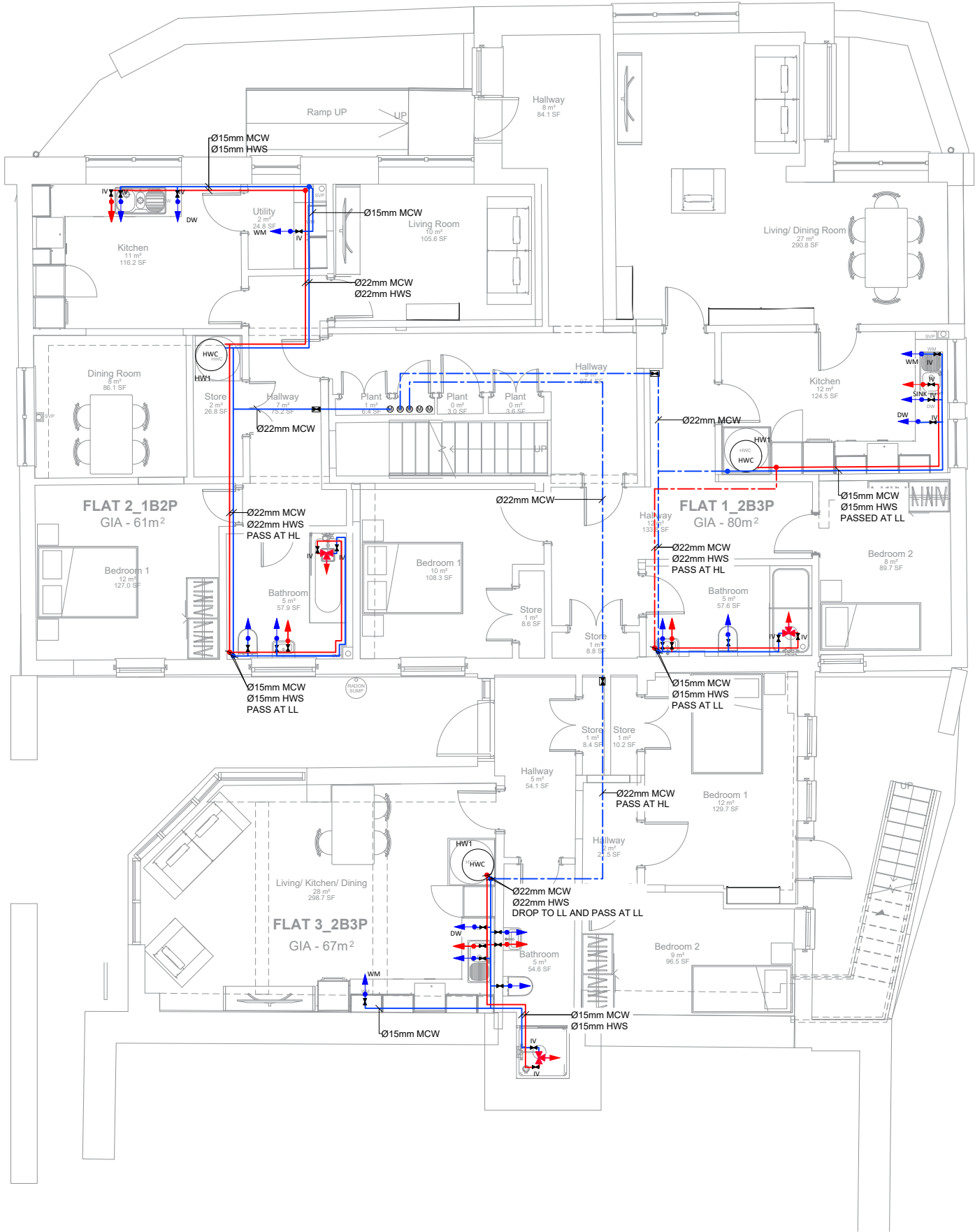

LEGEND

MCW LOW LEVEL

MCW HIGH LEVEL

MCW CONCEALED LEVEL

HW LOW LEVEL

HW HIGH LEVEL

HW CONCEALED LEVEL

ISOLATION VALVE

SURESTOP VALVE WITH REMOTE SWITCH

© COPYRIGHT EDP:  
THIS DRAWING REMAINS THE PROPERTY OF EDP ENVIRONMENTAL.  
NOTE: DO NOT SCALE FROM THIS DRAWING. ALL DIMENSIONS SHALL BE CHECKED ON SITE. ONLY FIGURED DIMENSIONS SHALL BE USED. IF IN DOUBT, ASK.  
THIS DRAWING SHALL BE READ IN CONJUNCTION WITH ALL RELEVANT DRAWINGS, DOCUMENTS AND INFORMATION PREPARED BY THE ARCHITECT, OTHER CONSULTANTS AND SPECIALISTS.  
THIS DRAWING SHALL BE READ IN CONJUNCTION WITH EDP ENVIRONMENTAL MECHANICAL & ELECTRICAL SERVICES SPECIFICATION & TECHNICAL SCHEDULES

HEALTH & SAFETY  
STANDARD CONSTRUCTION HAZARDS THAT A COMPETENT CONTRACTOR WOULD BE AWARE OF DURING NORMAL WORKING PRACTICES ARE NOT IDENTIFIED ON THIS DRAWING.  
RISKS THAT MAY NOT BE IMMEDIATELY APPARENT ARE LISTED BELOW.

## NOTES

- HOT AND COLD WATER SYSTEM WILL BE DESIGNED AND INSTALLED TO AVOID THE RISK OF MICROBIAL CONTAMINATION IN ACCORDANCE WITH GUIDANCE FROM HSE ACOP AND CIBSE TM13.
- MAKE DUE ALLOWANCE FOR PIPEWORK MOVEMENT FROM EXPANSION/CONTRACTION AND TO LIMIT ANY NOISE.
- ALL HOT AND COLD WATER SERVICES INSTALLATION PIPEWORK WHERE VISIBLE SHALL BE INSTALLED USING COPPER TUBES TO BS EN 1087 R250 WITH CAPILLARY SOLDERED FITTINGS.
- FIT DRAIN VALVES AT ALL LOW POINTS IN THE SYSTEM AND AAVS AT HIGH POINTS.
- ALL HOT & COLD WATER SERVICES PIPEWORK IN SHALL BE INSULATED IN ACCORDANCE WITH CURRENT REGULATIONS.
- INSULATION ON PIPEWORK TO HAVE A GWP LESS THAN 5.
- DOUBLE CHECK VALVES TO BE INSTALLED ON HOT & COLD PIPEWORK WHICH FEED BATHS WITH TMVS AND HAND HELD FLEXIBLE HOSES AS PER WATER REGULATIONS
- CONTRACTOR TO INSTALL FIRE PROTECTION FOR PIPEWORK PASSING THROUGH FIRE WALLS AND FLOORS.
- SURESTOP VALVE WITH REMOTE SWITCH - REMOTE SWITCH TO BE SITED AT LOW LEVEL FOR EASY ACCESS.

P03	11.07.25	UPDATED DRAWING FOR STAGE 4
P02	27.02.25	UPDATED LAYOUT
P01	25.02.25	FIRST ISSUE
REV	DATE	REVISION DESCRIPTION

## SCHEDULE OF REVISIONS

Architects Model:  
Structural Model:  
Other Model:  
Model Schedule Key: [Discipline] \_ [Date Received] \_ [Revision] \_ [Specific Model Number]



HEAD OFFICE  
EMBLEM HOUSE  
PYNES HILL  
EXETER, EX2 5BA  
EXETER T: 01392 367 237  
BRISTOL T: 01173 258 975  
FAREHAM T: 01329 800 710  
LONDON T: 02076 091 899  
CHOBHAM T: 01276 300 280

CLIENT:  
COUNCIL OF THE ISLES OF SCILLY

PROJECT:  
PARK HOUSE, ISLES OF SCILLY  
DRAWING TITLE:  
DOMESTIC WATER  
GROUND FLOOR

SERVICE TYPE:  
PUBLIC HEALTH  
DRAWING STATUS CODE:  
REVIEW AND COMMENT

SCALE @ A1 1:50	INTERNAL PROJECT REF: 2606
--------------------	-------------------------------

DRAWING NUMBER:  
2606-EDP-XX-00-DR-P-1000  
PROJECT NUMBER - ORIGINATOR - ZONE - LEVEL - TYPE - ROLE - SEQUENTIAL NUMBER

Designed by:	Drawn by:	Checked by:	Revision:
NO	NO	SO	P03